

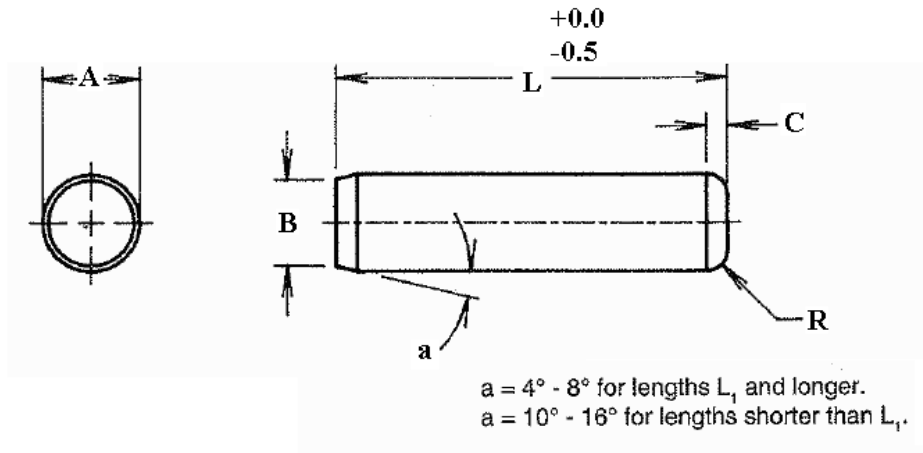

### Pin, Dowel, Metric, Manufactured in the USA

The information below lists the required dimensional, chemical and physical characteristics of the products in this purchase order. If the order received does not meet these requirements, it may result in a supplier corrective action request, which could jeopardize your status as an approved vendor. Unless otherwise specified, all referenced consensus standards must be adhered to in their entirety.



Nominal Size or Nominal Pin Diameter	A		B		C	R	L (1)
	Pin Diameter		Point Diameter		Crown Height	Crown Radius	Nominal
	Max.	Min.	Max.	Min.	Max.	Min.	Min.
3	3.008	3.003	2.9	2.6	0.8	0.3	4.0
4	4.009	4.004	3.9	3.6	0.9	0.4	4.5
5	5.009	5.004	4.9	4.6	1.0	0.4	4.5
6	6.01	6.004	5.8	5.4	1.1	0.4	5.0
8	8.012	8.006	7.8	7.4	1.3	0.5	5.5
10	10.012	10.006	9.8	9.4	1.4	0.6	6.0
12	12.013	12.007	11.8	11.4	1.6	0.6	6.0
16	16.013	16.007	15.8	15.3	1.8	0.8	7.0
20	20.014	20.008	19.8	19.3	2.0	0.8	7.0

(1). The minimum nominal length listed above is the shortest length to accommodate standard end configurations.

### Specification Requirements:

- Dimensions: ASME B18.8.5M
- Material & Mechanical Properties: Hardened ground machined carbon or alloy steel. Sulfur and Phosphorus content must not be in excess of 0.05 and 0.04 percent, respectively. Case hardness minimum 60 HRC, Case depth to be .25mm minimum for nominal pin sizes 4 mm or smaller and 0.38mm for nominal pins larger than 4mm. Core hardness of 50-58 HRC.
- Finish: Black Lustre